

FEMMINA METRICA CON CONO / O-RING 24° SERIE PESANTE DKOS
 METRIC FEMALE WITH 24° TAPER / O-RING HEAVY DKOS SERIES

Materiale Material	Finitura superficiale Surface Finishing
Acciaio AVP Carbon Steel	Zincatura trivalente Zinc Plating

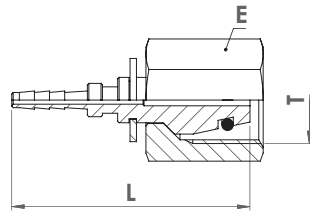

Codice Part Number	Diametro tubo Hose Size			Filetto Thread	Codolo Pipe	Dimensioni Dimensions (mm)	
	inch	mm	size	T		L	E
RTSFD14156DIN	1/12"	2,1	-	M14x1,5	6	32	17
RTSFD16158DIN	1/12"	2,1	-	M16x1,5	8	35	19
RTSFD181510DIN	1/12"	2,1	-	M18x1,5	10	32	22
RTSFD201512DIN	1/12"	2,1	-	M20x1,5	12	34	24
RPFDKOS1415DN3	1/8"	3,0	02	M14x1,5	6	35	17
RPFDKOS1615DN3	1/8"	3,0	02	M16x1,5	8	35	19
RPFDKOS1815DN3	1/8"	3,0	02	M18x1,5	10	37	22
RPFDKOS1415486	5/32"	4,0	02,5	M14x1,5	6	36	17
RPFDKOS1615488	5/32"	4,0	02,5	M16x1,5	8	36	19
RPFDKOS18154810	5/32"	4,0	02,5	M18x1,5	10	37	22
RPFDKOS20154812	5/32"	4,0	02,5	M20x1,5	12	40	24

FEMMINA METRICA 90° CON CONO / O-RING 24° SERIE PESANTE DKOS
 METRIC FEMALE 90° WITH 24° TAPER / O-RING HEAVY DKOS SERIES

Materiale Material	Finitura superficiale Surface Finishing
Acciaio AVP Carbon Steel	Zincatura trivalente / Zinc Plating

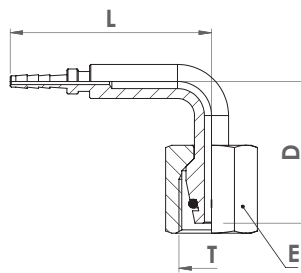

Codice Part Number	Diametro tubo Hose Size			Filetto Thread	Codolo Pipe	Dimensioni Dimensions (mm)		
	inch	mm	size	T		L	D	E
RTSF901415DIN	1/12"	2,1	-	M14x1,5	6	25	25	17
RTSF901615DIN	1/12"	2,1	-	M16x1,5	8	25	25	19
RTSF90181510DIN	1/12"	2,1	-	M18x1,5	10	42	40	22
RPF90DKOS1415DN3	1/8"	3,0	02	M14x1,5	6	39	25	17
RPF90DKOS1615DN3	1/8"	3,0	02	M16x1,5	8	41	36	19
RPF90DKOS1815DN3	1/8"	3,0	02	M18x1,5	10	47	40	22
RPF90DKOS1415486	5/32"	4,0	02,5	M14x1,5	6	39	25	17
RPF90DKOS1615488	5/32"	4,0	02,5	M16x1,5	8	46	36	19
RPF90DKOS18154810	5/32"	4,0	02,5	M18x1,5	10	47	40	22
RPF90DKOS20154812	5/32"	4,0	02,5	M20x1,5	12	47	40	24